

KPDA Media Weekly Review Report as at 21st August 2020



CEO DE-BRIEF

KPDA Platinum Members
KPDA
KENYA PROPERTY DEVELOPERS ASSOCIATION

ALN
Anjarwalla & Khana Advocates

BA
Balala & Abed Advocates

FUSION CAPITAL
Rooted in the African growth story
Fusion Capital Ltd

MI VIDA
MY HOME, MY LIFE
Prism Residential Ltd

HFDI
Dreams Made Possible
HF Development and Investments Ltd

NCBA
NCBA Bank Kenya PLC

NEWLINE
Office Furniture & Kitchens
Newline Ltd

YASIAN Interiors
Living with Quality
Yasian Technology Company td

TWO RIVERS
Two Rivers Development Ltd

SYMBION
Symbion Kenya Ltd

SAVANNAH CEMENT
Building Perfection
Savannah Cement Ltd

KCB
Making the Difference
KCB Bank Kenya Ltd

MRM
MABATI ROLLING MILLS
Mabati Rolling Mills Ltd

KONE
Elevators Escalators
Kone Kenya Ltd

Britam
With you every step of the way
Britam Asset Managers

From the evidence so far, the new coronavirus can be transmitted in ALL AREAS, including areas with hot and humid weather.

Regardless of climate, adopt protective measures if you live in, or travel to an area reporting COVID-19.

The best way to protect yourself against COVID-19 is by frequently cleaning your hands. Eliminate viruses that may be on your hands and avoid infection that could occur by then touching your eyes, mouth, and nose.

FACT:
The new coronavirus can be transmitted in areas with hot and humid climates

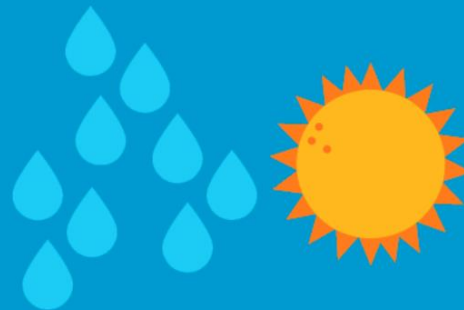

ADVERTISE WITH US: WE ARE GIVING YOU AN 80% DISCOUNT!!!!

KPDA
KENYA PROPERTY DEVELOPERS ASSOCIATION

ADVERTISE WITH KPDA AT AN 80% DISCOUNT!

Why Advertise through KPDA Media

Your Ad will run on these platforms:

- The KPDA Website
- The KPDA Media Weekly Review Reports
- KPDA Social Media Platforms: Facebook, Twitter and LinkedIn
- KPDA's Email Listing

AD Requirements:

- JPG or PNG format
- 72 dpi resolution
- Colour calibration RGB
- Size should not exceed 30KB

Advertising Terms and Conditions

- Advertisements will only be run upon receipt of payment
- All information and Material supplied to KPDA should be true, accurate and not misleading, and nothing contained in it is liable to bring KPDA into disrepute
- The Material shall not indicate an intention to discriminate on grounds of sex, race, religion or belief, disability, ethnic origin, age or sexual orientation (unless such an Advertisement is exempted from any statutory requirements relating to such forms of discrimination and the Customer notifies KPDA of the applicability of such an exemption at the time when the Advertisement is submitted to KPDA);
- KPDA reserves the right to determine the appropriateness of ad content and not run advertisements deemed to contract KPDA's Code of Conduct and values. In the event that KPDA declines to run an advertisement, the customer shall be refunded for the amount they will have paid.

What is the Cost of Advertising with KPDA?

We will run your ad for a period of four (4) weeks (one month) at an 80% discount!!!

- **KPDA Members:-**
Kshs. 3, 420 VAT Incl
- **Non-Members:-**
Kshs. 5, 700 VAT Incl

Payment must be received prior to the commencement of advertising. An invoice shall be issued upon confirmation to facilitate the processing of payment.

KPDA Advertising Platform Statistics

The KPDA Website - www.kpda.or.ke:

- 10, 000 visitors per month
- 7, 000 visitors on Mondays and Wednesdays

KPDA on Twitter @KPDA_Ke:

- 5, 040 followers
- 14, 000 impressions per month

The KPDA Media Weekly Review Report

- Over 1, 500 subscribers
- An organic reach of over 500 subscribers

LinkedIn - Kenya Property Developers Association:

- 2, 732 followers
- Over 500 views per day

Facebook page - Kenya Property Developers Association:

- 3, 360 followers and 3, 232 likes
- An organic reach of over 1, 500

Email Contacts - ceo@kpda.or.ke, membership@kpda.or.ke, kpdasecretariat@gmail.com

- Over 1, 000 email contacts

For more information,
please call: 0725 286 689 / 0737 530 290
or email: ceo@kpda.or.ke.

www.kpda.or.ke
KPDA_Ke
Kenya Property Developers Association
Kenya Property Developers Association

Reach out to us on ceo@kpda.or.ke. Click [here](#) to view the flyer

CO-WORKING SPACE AVAILABLE!!! - BOOGERTMAN+PARTNERS

With a high speed internet, 24/7 round the clock access, sufficient storage display/shelves, digital display, a serviced office space and much more, Boogertman+Partners have a co-working space to let. Feel free to contact them on:

Phone: +254 736 399 361/ +254 204 408 990

Email: margaret@boogertman.co.ke

For more information, please click [HERE](#)

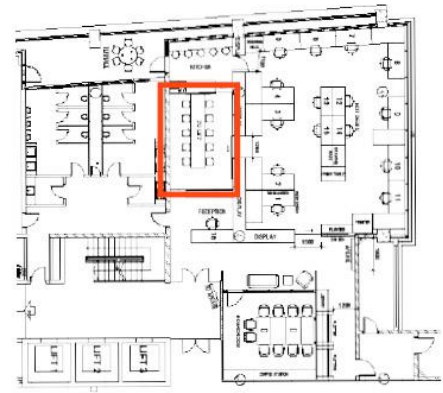

96 RIVERSIDE DRIVE, RIVERSIDE

Shared Office space

- + Nett Rentable Area: 25sqm
- + High Speed Internet
- + High Touch concierge reception services
- + Storage Shelves Available
- + Accessible private Terrace

KES 100,000 Per Month

For more info contact :
 +254 736 399 361/ +254 204 408 990
 mail@boogertman.co.ke



21st August 2020

The Standard | Sara Okuro | Friday 21st August 2020

KONZA MAKES ROOM FOR SME PARK AND LIGHT INDUSTRIAL MANUFACTURING

Konza Technopolis Development Authority, the agency implementing the Konza Technopolis project, has set aside space for the establishment of a smart and sustainable [SME Park and Light Manufacturing Centre](#). [Read More.](#)

Business Daily | Brian Ngugi | Friday 21st August 2020

NEW PLAN TO GIVE INVESTORS COMPLETE REAL ESTATE DATA

Kenya is looking to plug data gaps in the real estate market so investors and households can easily access information to track prices of rents and identify investment opportunities. [Read More.](#)

Business Daily | Sam Kiplagat | Friday 21st August 2020

TYCOON FAILS IN BID TO SEIZE AG, PS ASSETS OVER DEMOLISHED SPRING VALLEY HOME

Reclusive tycoon Mike Maina Kamau has lost a bid to attach the properties of the Attorney General and Infrastructure PS Paul Maringa for disobeying a court order over a Sh859 million compensation for his mansion, which was demolished in Nairobi's Spring Valley. [Read More.](#)

Business Daily | Doreen Wainainah | Friday 21st August 2020

SA'S MASSMART OPENS SH500M BUILDING MATERIALS MART IN KAREN

South African retail giant Massmart has increased its footprint in Kenya with the opening of a new Sh500 million building material outlet at the Waterfront Mall in Karen. [Read More.](#)

20th August 2020

The Standard | Philip Mwakio | Thursday 20th August 2020

REJECTED STONE? WOMEN IN BUILDING SECTOR SHRINK

In Kenya today, the number of women involved in the construction industry remains at an all-time low compared to their male counterparts. [Read More.](#)

The Standard | James Wanzala | Thursday 20th August 2020

TOP BRANDS TAKE UP SPACE AT FORMER NAKUMATT STORE

The site of the former Nakumatt Mega along Uhuru Highway is now occupied by top global retailers, with Carrefour as the anchor tenant. [Read More.](#)

The Standard | Wainaina Wambu | Thursday 20th August 2020

FAULTY LEASES HOLD TENANTS, LANDLORDS IN TOXIC EMBRACE

The outcome of a court case between Africa's biggest supermarket and its former landlord, The Waterfront Karen Mall, has drawn interest in Kenya's retail circles. [Read More.](#)

Business Daily | Scott Bellows | Thursday 20th August 2020

THE ARCHITECTURE OF REAL ESTATE DOWN PAYMENTS

Up and down our great country, real estate developers and land subdividing and onward selling agencies thrive by capturing the dreams and ambitions of Kenyans from all walks of life. [Read More.](#)

Business Daily | James Kariuki | Thursday 20th August 2020

YEGO PROPERTY AUCTION FIXED AS COURT BID FLOPS

Auctioneers have re-advertised retired African Inland Church (AIC) Bishop Silas Yego's prime Kileleshwa property over Sh143 million owed Transnational Bank following a failed bid by the clergyman to stop the sale. [Read More.](#)

19th August 2020

Business Daily | Victor Raballa | Wednesday 19th August 2020

KISUMU'S BUSINESS PARK OPENS OCTOBER

Kisumu County government will in October open the first phase of the multi-million shilling Uhuru Business Park Complex for 5,000 traders who were evicted to give room for the expansion of Sh3 billion inland port. [Read More.](#)

18th August 2020

Business Daily | Sam Kiplagat | Tuesday 18th August 2020

SURAYA HOME BUYERS RISK MILLIONS IN AUCTION OF LAND

Home buyers risk losing millions of shillings paid to Suraya property Group after the High Court allowed Transnational Bank to auction a one-acre parcel of land on Kiambu Road that was to host the houses. [Read More.](#)

Business Daily | Joseph Wangui | Tuesday 18th August 2020

LAPFUND TAKES OVER MARIKANI ESTATE AS SUIT FLOPS

The Local Authorities Pension Fund (Lapfund) has taken control and management of Mariakani residential estate in Nairobi after the Court of Appeal declined to grant a request to stop the takeover. [Read More.](#)

17th August 2020

Business Daily | Sam Kiplagat | Monday 17th August 2020

POLICE AND WOMEN GROUP RENEW FIGHT FOR 70-ACRE SOUTH C LAND

The dispute over the ownership of a 70-acre parcel in Nairobi's South-C area claimed by the police has taken a new turn after the appellate court set aside orders granted a decade ago prohibiting the eviction of a group of squatters from the land. [Read More.](#)

For more information on the **KPDA Media Weekly Review Report**, kindly contact the
KPDA Secretariat on **0737 530 290** or **0725 286 689** or by emailing
ceo@kpda.or.ke

Copyright©* | 2018 | *Kenya Property Developers Association, All rights reserved.