

# KPDA Media Weekly Review Report as at 6<sup>th</sup> September 2020



# CEO DE-BRIEF

**KPDA Platinum Members**  
**KPDA**  
KENYA PROPERTY DEVELOPERS ASSOCIATION

**ALN**  
Anjarwalla & Khana Advocates

**BA**  
Balala & Abed Advocates

**FUSION CAPITAL**  
Rooted in the African growth story  
Fusion Capital Ltd

**MI VIDA**  
MY HOME, MY LIFE  
Prism Residential Ltd

**HFDI**  
Dreams Made Possible  
HF Development and Investments Ltd

**NCBA**  
NCBA Bank Kenya PLC

**NEWLINE**  
Office Furniture & Kitchens  
Newline Ltd

**YASIAN Interiors**  
Living with Quality  
Yasian Technology Company td

**TWO RIVERS**  
Two Rivers Development Ltd

**SYMBION**  
Symbion Kenya Ltd

**SAVANNAH CEMENT**  
Building Perfection  
Savannah Cement Ltd

**KCB**  
Making the Difference  
KCB Bank Kenya Ltd

**MRM**  
MABATI ROLLING MILLS  
Mabati Rolling Mills Ltd

**KONE**  
Elevators Escalators  
Kone Kenya Ltd

**Britam**  
With you every step of the way  
Britam Asset Managers

From the evidence so far, the new coronavirus can be transmitted in ALL AREAS, including areas with hot and humid weather.

Regardless of climate, adopt protective measures if you live in, or travel to an area reporting COVID-19.

The best way to protect yourself against COVID-19 is by frequently cleaning your hands. Eliminate viruses that may be on your hands and avoid infection that could occur by then touching your eyes, mouth, and nose.

**FACT:**  
The new coronavirus can be transmitted in areas with hot and humid climates

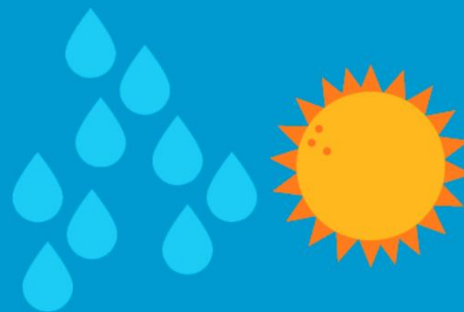



# ADVERTISE WITH US: WE ARE GIVING YOU AN 80% DISCOUNT!!!!

**KPDA**  
KENYA PROPERTY DEVELOPERS ASSOCIATION

## ADVERTISE WITH KPDA AT AN 80% DISCOUNT!

**Why Advertise through KPDA Media**

Your Ad will run on these platforms:

- ★ The KPDA Website
- ★ The KPDA Media Weekly Review Reports
- ★ KPDA Social Media Platforms: Facebook, Twitter and LinkedIn
- ★ KPDA's Email Listing

**AD Requirements:**

- ★ JPG or PNG format
- ★ 72 dpi resolution
- ★ Colour calibration RGB
- ★ Size should not exceed 30KB

**Advertising Terms and Conditions**

- Advertisements will only be run upon receipt of payment
- All information and Material supplied to KPDA should be true, accurate and not misleading, and nothing contained in it is liable to bring KPDA into disrepute
- The Material shall not indicate an intention to discriminate on grounds of sex, race, religion or belief, disability, ethnic origin, age or sexual orientation (unless such an Advertisement is exempted from any statutory requirements relating to such forms of discrimination and the Customer notifies KPDA of the applicability of such an exemption at the time when the Advertisement is submitted to KPDA);
- KPDA reserves the right to determine the appropriateness of ad content and not run advertisements deemed to contract KPDA's Code of Conduct and values. In the event that KPDA declines to run an advertisement, the customer shall be refunded for the amount they will have paid.

**What is the Cost of Advertising with KPDA?**

We will run your ad for a period of four (4) weeks (one month) at an 80% discount!!!

- **KPDA Members:- Kshs. 3, 420 VAT Incl**
- **Non-Members:- Kshs. 5, 700 VAT Incl**

Payment must be received prior to the commencement of advertising. An invoice shall be issued upon confirmation to facilitate the processing of payment.

**KPDA Advertising Platform Statistics**

**The KPDA Website - www.kpda.or.ke:**

- 10, 000 visitors per month
- 7, 000 visitors on Mondays and Wednesdays

**The KPDA Media Weekly Review Report**

- Over 1, 500 subscribers
- An organic reach of over 500 subscribers

**Facebook page - Kenya Property Developers Association:**

- 3, 360 followers and 3, 232 likes
- An organic reach of over 1, 500

**KPDA on Twitter @KPDA\_Ke:**

- 5, 040 followers
- 14, 000 impressions per month

**LinkedIn - Kenya Property Developers Association:**

- 2, 732 followers
- Over 500 views per day

**Email Contacts - ceo@kpda.or.ke, membership@kpda.or.ke, kpdasecretariat@gmail.com**

- Over 1, 000 email contacts

**For more information,** please call: 0725 286 689 / 0737 530 290 or email: ceo@kpda.or.ke

www.kpda.or.ke  
KPDA\_Ke  
Kenya Property Developers Association  
Kenya Property Developers Association

Reach out to us on [ceo@kpda.or.ke](mailto:ceo@kpda.or.ke). Click [here](#) to view the flyer

## CO-WORKING SPACE AVAILABLE!!! - BOOGERTMAN+PARTNERS

With Kshs. 100, 000 at Allianz Plaza, Riverside drive, Boogertman +Partners is letting you an office space and the following amenities are inclusive of the price:

- Concierge services including mail handling and receptionist services.
- Use of Connect Coffee lounge and of the private member all weather terrace for informal meetings, breakout and collaboration areas featuring relaxed contemporary seating designed to encourage interaction.
- Use of board rooms featuring state of the art technology for 8 hours a month. Use of board rooms beyond this is chargeable at a member rate of \$30 + VAT per hour.
- 24-hour access.
- Grade A building featuring secure access, 3 high speed lifts, fire suppression, backup generator, back up and water supply.
- Member self-serve kitchen offering unlimited tea, coffee & water.
- High speed secure Wi-Fi.

Contact them at [margaret@boogertman.co.ke](mailto:margaret@boogertman.co.ke) or call +254 736 399 361/ +254 204 408 990

For more information, please click [HERE](#)

## ALLIANZ PLAZA, RIVERSIDE DRIVE

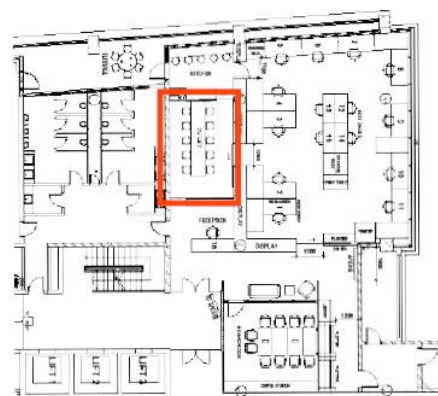

### 96 RIVERSIDE DRIVE, RIVERSIDE

#### Shared Office space

- + Nett Rentable Area: 25sqm
- + High Speed Internet
- + High Touch concierge reception services
- + Storage Shelves Available
- + Accessible private Terrace

KES 100,000 Per Month

For more info contact:  
+254 736 399 367 / +254 204 408 990  
mail@boogertman.co.ke



TILISI IS TAKING SHAPE: HAVE A LOOK!!!



# Tilisi is taking shape



Completed Phase I infrastructure



Phase II construction ongoing



Africa Logistics Properties on track for opening this October



Ongoing construction of Tilisi Views

Fully serviced land parcels from 1 acre available for logistics, commercial, residential, education, medical & recreation

## Strategic Location

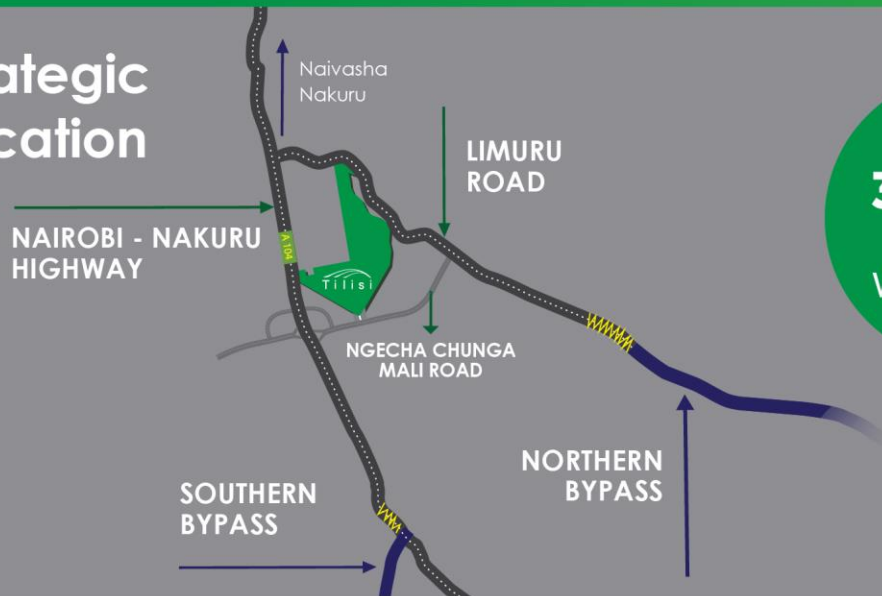

**ONLY  
30 MINS  
FROM  
WESTLANDS**

## Contacts

+254 714 845 474

[www.tilisi.co.ke](http://www.tilisi.co.ke)

[sales@tilisi.co.ke](mailto:sales@tilisi.co.ke)

To view/download, click [HERE](#)

TAWI PAINTS, THE NEW KID IN TOWN!!!



# Paint Specialist

Exterior & Interior

## OUR PRODUCTS

- ✓ Tawi Vinyl Matt Emulsion
- ✓ Tawi Vinyl Silk Emulsion
- ✓ Tawi Weatherguard Premium Coating
- ✓ Tawi Covermatt Emulsion
- ✓ Tawi Textured Tough
- ✓ Acrylic Primer Sealer Undercoat
- ✓ Tawi Economy Undercoat

## WHY CHOOSE US?

Premium quality paint offering maximum protection on both interior and exterior surfaces. Suitable for new and previously painted plaster, cement, brick, stone, soft board and hardboard ceilings, walls and asbestos sheets amongst others.



### Kipepeo Industries Limited

P.O Box 15509 00509, Nairobi

**T:** Sales Department: +254 110 000 080/089

+254 757 775 718/719/713

**E:** info@tawipaints.co.ke/sales@tawipaints.co.ke

**W:** www.tawipaints.co.ke

**f** @tawipaints **t** @TawiPaints

To view/download, click [HERE](#)

## 6<sup>th</sup> September 2020

The Standard | Peter Theuri | Sunday, 6<sup>th</sup> September 2020

### ROADS AGENCIES HOPEFUL AS COVID STALLS BIG PROJECTS

The Covid-19 pandemic has slowed down construction, causing uncertainty on the completion of multiple projects across the country. [Read More.](#)

The Standard | Japheth Ogila | Sunday, 6<sup>th</sup> September 2020

### LET'S SUSPEND POLITICS, PRIOTISE BIG FOUR AGENDA- DP RUTO

Deputy President William Ruto has called on state officers across various cadres to priotise achieving objectives of Big Four Agenda before engaging in politics. [Read More.](#)

## 5<sup>th</sup> September 2020

The Standard | Harold Odhiambo | Saturday, 5<sup>th</sup> September 2020

### KISUMU'S NEW POSH ESTATES FOR THE RICH

Wealthy businessmen and politicians are transforming Kisumu city's outlying areas into a residential paradise, thanks to land shortage in the once-famous neighbourhoods. [Read More.](#)

## 4<sup>th</sup> September 2020

Business Daily | Collins Omulo | Friday, 4<sup>th</sup> September 2020

### WILL COMMUNAL POOLS, GYMS, CLUBHOUSES LOSE APPEAL?

When Purity Wanjiru was shopping for an apartment to live in with her family, a swimming pool and a gym were some of the amenities she prioritised. [Read More.](#)

Business Daily | Douglas Kierene | Friday, 4<sup>th</sup> September 2020

### ANCESTRAL LAND CAN BE CONVERTED INTO REAL CAPITAL

I have been following a series of articles by Bitange Ndemo on what he describes as "dead capital", with interest. [Read More.](#)

## 3<sup>rd</sup> September 2020

The Standard | Macharia Kamau | Thursday, 3<sup>rd</sup> September 2020

### MAGANA FARM YIELDS TO SCENT OF REAL ESTATE, SHUTS DOWN

Monday was the last day for Magana Flowers. The giant horticulture employer in Kikuyu, Kiambu County has shut down citing insurmountable challenge. [Read More.](#)

The Standard | Reuters | Thursday, 3<sup>rd</sup> September 2020

### HOW VIRUS COULD SHAPE PLANNING OF FUTURE MEGACITIES

The Covid-19 pandemic has exposed the vulnerability of densely populated cities with crowded accommodation and public transportation systems to the transmission of airborne viruses. [Read More.](#)

The Standard | Peter Theuri | Thursday, 3<sup>rd</sup> September 2020

### COVID-19 WIDENS CRACKS IN OFF-PLAN HOME OWNERSHIP

Towards the end of last year, the High Court in Kiambu had a determination to make in a suit involving various parties in the construction industry. [Read More.](#)

**The Standard | Jacinta Mutura | Thursday, 3<sup>rd</sup> September 2020**

**SACCO MAKES UNLIKELY HOMEOWNERS**

In the interior of Laikipia North, a kilometre from Rumuruti town, bare land dotted with shrubs and manyattas paints a picture of an austere life. [Read More.](#)

**The Standard | Reuters | Thursday, 3<sup>rd</sup> September 2020**

**PANDEMIC SPAWNS EXODUS TO TORONTO SUBURBS**

The coronavirus pandemic is speeding up an exodus to Toronto's suburbs and beyond as white-collar workers, frustrated with the city's lack of family-friendly homes, bet they will be able to continue working from home after the crisis ends. [Read More.](#)

**1<sup>st</sup> September 2020**

**Business Daily | Data Hub | Tuesday, 1<sup>st</sup> September 2020**

**MAKEOVERS RAISE HOPE OF IMPROVED RAIL TRANSPORT IN NAIROBI METROPOLITAN**

After many years of promises, missed deadlines and growing pain of nauseating traffic gridlock, Nairobi's commuter rail travel looks set for a big come back. [Read More.](#)

**Business Daily | Patrick Alushula | Tuesday, 1<sup>st</sup> September 2020**

**CENTUM EYES LOWER DIVIDEND OVER COVID-19**

Chief executive at Centum James Mworira says in the latest annual report that Covid-19 has hurt the performance of its private equity businesses and this will result in reduced dividend income. [Read More.](#)

For more information on the **KPDA Media Weekly Review Report**, kindly contact the  
KPDA Secretariat on **0737 530 290** or **0725 286 689** or by emailing  
[ceo@kpda.or.ke](mailto:ceo@kpda.or.ke)

Copyright©\* | 2018 | \*Kenya Property Developers Association, All rights reserved.